

# Encompass

ENGINEERING & SURVEYING

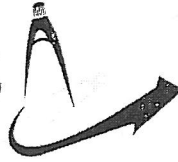

Together with  
**Baima & Holmberg**



## LEGAL DESCRIPTION WEIS TO LAWLER

THAT PORTION OF LOT 10 OF THAT CERTAIN SURVEY AS RECORDED IN BOOK 31 OF SURVEYS AT PAGE 226, UNDER AUDITOR'S FILE NUMBER 200510310018 RECORDS OF SAID COUNTY, WHICH IS BOUNDED BY THE FOLLOWING DESCRIBED LINE:

COMMENCING AT THE NORTHEAST CORNER OF SAID LOT 4 SAID CORNER BEING THE TRUE POINT OF BEGINNING OF SAID LINE; THENCE NORTH 39°37'47" EAST 133.63 FEET; THENCE NORTH 50°22'13" WEST 223.72 FEET; THENCE SOUTH 64°39'32" WEST 58.66 FEET TO THE BEGINNING OF A NON-TANGENT CURVE CONCAVE TO THE NORTHWEST HAVING A RADIAL BEARING OF SOUTH 87°36'19" WEST AND A RADIUS OF 80.00 FEET; THENCE SOUTHERLY ALONG SAID CURVE 61.50 FEET THROUGH A CENTRAL ANGLE OF 44°02'55"; THENCE SOUTH 26°19'19" EAST 16.55 FEET TO THE BEGINNING OF A CURVE TO THE LEFT HAVING A RADIUS OF 200.00 FEET; THENCE ALONG SAID CURVE TO THE LEFT 83.95 FEET THROUGH A CENTRAL ANGLE OF 24°02'55", MORE OR LESS, TO THE NORTHWEST CORNER OF SAID LOT 4; THENCE SOUTH 50°22'13" EAST 131.41 FEET, MORE OR LESS, TO THE TRUE POINT OF BEGINNING AND TERMINUS OF SAID LINE.

CONTAINING 0.70 ACRES

AND THAT PORTION OF SAID LOT 10 WHICH IS BOUNDED BY A LINE DESCRIBED AS FOLLOWS:

COMMENCING AT THE NORTHEAST CORNER OF SAID LOT 4; THENCE SOUTH 39°37'47" WEST, ALONG THE EASTERLY BOUNDARY LINE OF SAID LOT 4, 332.05 FEET TO THE SOUTHEAST CORNER OF SAID LOT 4 AND THE TRUE POINT OF BEGINNING OF SAID LINE; THENCE CONTINUING SOUTH 39°37'47" WEST 119.94 FEET, MORE OR LESS, TO THE SOUTHERLY BOUNDARY LINE OF SAID LOT 10; THENCE NORTH 43°50'00" WEST, ALONG SAID SOUTHERLY BOUNDARY LINE OF SAID LOT 10, 149.57 FEET; THENCE NORTH 41°53'35" EAST 110.05 FEET, MORE OR LESS, TO THE SOUTHWEST CORNER OF SAID LOT 4; THENCE SOUTH 47°34'21" EAST, ALONG THE SOUTHERLY BOUNDARY LINE OF SAID LOT 4, 144.42 FEET, MORE OR LESS, TO THE TRUE POINT OF BEGINNING OF SAID LINE.

CONTAINING 0.39 ACRES

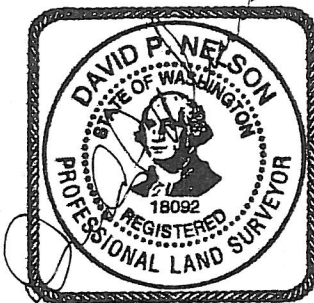

### Western Washington Division

165 NE Juniper St., Ste 201, Issaquah, WA 98027  
Phone: (425) 392-0250 Fax: (425) 391-3055

### Eastern Washington Division

108 East 2<sup>nd</sup> Street, Cle Elum, WA 98922  
Phone: (509) 674-7433 Fax: (509) 674-7419

# Encompass

ENGINEERING & SURVEYING

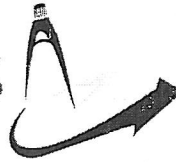

Together with  
**Baima & Holmberg**



## LEGAL DESCRIPTION PARCEL A

LOT 10 OF THAT CERTAIN SURVEY AS RECORDED IN BOOK 31 OF SURVEYS AT PAGE 226, UNDER AUDITOR'S FILE NUMBER 200510310018 RECORDS OF KITTITAS COUNTY, STATE OF WASHINGTON;

EXCEPT THAT PORTION OF SAID LOT 10 WHICH IS BOUNDED BY A LINE DESCRIBED AS FOLLOWS:

COMMENCING AT THE NORTHEAST CORNER OF LOT 4 AS RECORDED IN BOOK 8 OF PLATS AT PAGES 197-200, UNDER AUDITOR'S FILE NUMBER 200009130033, RECORDS OF SAID COUNTY, SAID CORNER BEING THE TRUE POINT OF BEGINNING OF SAID LINE; THENCE NORTH 39°37'47" EAST 133.63 FEET; THENCE NORTH 50°22'13" WEST 223.72 FEET; THENCE SOUTH 64°39'32" WEST 58.66 FEET TO THE BEGINNING OF A NON-TANGENT CURVE CONCAVE TO THE NORTHWEST HAVING A RADIAL BEARING OF SOUTH 87°36'19" WEST AND A RADIUS OF 80.00 FEET; THENCE SOUTHERLY ALONG SAID CURVE 61.50 FEET THROUGH A CENTRAL ANGLE OF 44°02'55"; THENCE SOUTH 26°19'19" EAST 16.55 FEET TO THE BEGINNING OF A CURVE TO THE LEFT HAVING A RADIUS OF 200.00 FEET; THENCE ALONG SAID CURVE TO THE LEFT 83.95 FEET THROUGH A CENTRAL ANGLE OF 24°02'55", MORE OR LESS, TO THE NORTHWEST CORNER OF SAID LOT 4; THENCE SOUTH 50°22'13" EAST 131.41 FEET, MORE OR LESS, TO THE TRUE POINT OF BEGINNING AND TERMINUS OF SAID LINE.

AND EXCEPT THAT PORTION OF SAID LOT 10 WHICH IS BOUNDED BY A LINE DESCRIBED AS FOLLOWS:

COMMENCING AT THE NORTHEAST CORNER OF LOT 4 AS RECORDED IN BOOK 8 OF PLATS AT PAGES 197-200, UNDER AUDITOR'S FILE NUMBER 200009130033, RECORDS OF SAID COUNTY; THENCE SOUTH 39°37'47" WEST, ALONG THE EASTERLY BOUNDARY LINE OF SAID LOT 4, 332.05 FEET TO THE SOUTHEAST CORNER OF SAID LOT 4 AND THE TRUE POINT OF BEGINNING OF SAID LINE; THENCE CONTINUING SOUTH 39°37'47" WEST 119.94 FEET, MORE OR LESS, TO THE SOUTHERLY BOUNDARY LINE OF SAID LOT 10; THENCE NORTH 43°50'00" WEST, ALONG SAID SOUTHERLY BOUNDARY LINE OF SAID LOT 10, 149.57 FEET; THENCE NORTH 41°53'35" EAST 110.05 FEET, MORE OR LESS, TO THE SOUTHWEST CORNER OF SAID LOT 4; THENCE SOUTH 47°34'21" EAST, ALONG THE SOUTHERLY BOUNDARY LINE OF SAID LOT 4, 144.42 FEET, MORE OR LESS, TO THE TRUE POINT OF BEGINNING OF SAID LINE.

CONTAINING 15.27 ACRES



### Western Washington Division

165 NE Juniper St., Ste 201, Issaquah, WA 98027  
Phone: (425) 392-0250 Fax: (425) 391-3055

### Eastern Washington Division

108 East 2<sup>nd</sup> Street, Cle Elum, WA 98922  
Phone: (509) 674-7433 Fax: (509) 674-7419

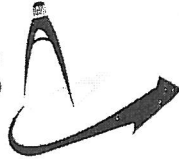

**LEGAL DESCRIPTION PARCEL B**

LOT 4 OF THAT CERTAIN SURVEY AS RECORDED IN BOOK 8 OF PLATS AT PAGES 197-200, UNDER AUDITOR'S FILE NUMBER 200009130033, RECORDS OF KITTITAS COUNTY, STATE OF WASHINGTON;

AND THAT PORTION OF LOT 10 OF THAT CERTAIN SURVEY AS RECORDED IN BOOK 31 OF SURVEYS AT PAGE 226, UNDER AUDITOR'S FILE NUMBER 200510310018 RECORDS OF SAID COUNTY, WHICH IS BOUNDED BY THE FOLLOWING DESCRIBED LINE:

COMMENCING AT THE NORTHEAST CORNER OF SAID LOT 4 SAID CORNER BEING THE TRUE POINT OF BEGINNING OF SAID LINE; THENCE NORTH 39°37'47" EAST 133.63 FEET; THENCE NORTH 50°22'13" WEST 223.72 FEET; THENCE SOUTH 64°39'32" WEST 58.66 FEET TO THE BEGINNING OF A NON-TANGENT CURVE CONCAVE TO THE NORTHWEST HAVING A RADIAL BEARING OF SOUTH 87°36'19" WEST AND A RADIUS OF 80.00 FEET; THENCE SOUTHERLY ALONG SAID CURVE 61.50 FEET THROUGH A CENTRAL ANGLE OF 44°02'55"; THENCE SOUTH 26°19'19" EAST 16.55 FEET TO THE BEGINNING OF A CURVE TO THE LEFT HAVING A RADIUS OF 200.00 FEET; THENCE ALONG SAID CURVE TO THE LEFT 83.95 FEET THROUGH A CENTRAL ANGLE OF 24°02'55", MORE OR LESS, TO THE NORTHWEST CORNER OF SAID LOT 4; THENCE SOUTH 50°22'13" EAST 131.41 FEET, MORE OR LESS, TO THE TRUE POINT OF BEGINNING AND TERMINUS OF SAID LINE.

AND THAT PORTION OF SAID LOT 10 WHICH IS BOUNDED BY A LINE DESCRIBED AS FOLLOWS:

COMMENCING AT THE NORTHEAST CORNER OF SAID LOT 4; THENCE SOUTH 39°37'47" WEST, ALONG THE EASTERLY BOUNDARY LINE OF SAID LOT 4, 332.05 FEET TO THE SOUTHEAST CORNER OF SAID LOT 4 AND THE TRUE POINT OF BEGINNING OF SAID LINE; THENCE CONTINUING SOUTH 39°37'47" WEST 119.94 FEET, MORE OR LESS, TO THE SOUTHERLY BOUNDARY LINE OF SAID LOT 10; THENCE NORTH 43°50'00" WEST, ALONG SAID SOUTHERLY BOUNDARY LINE OF SAID LOT 10, 149.57 FEET; THENCE NORTH 41°53'35" EAST 110.05 FEET, MORE OR LESS, TO THE SOUTHWEST CORNER OF SAID LOT 4; THENCE SOUTH 47°34'21" EAST, ALONG THE SOUTHERLY BOUNDARY LINE OF SAID LOT 4, 144.42 FEET, MORE OR LESS, TO THE TRUE POINT OF BEGINNING OF SAID LINE.

CONTAINING 2.13 ACRES



**Western Washington Division**

165 NE Juniper St., Ste 201, Issaquah, WA 98027  
Phone: (425) 392-0250 Fax: (425) 391-3055

**Eastern Washington Division**

108 East 2<sup>nd</sup> Street, Cle Elum, WA 98922  
Phone: (509) 674-7433 Fax: (509) 674-7419